

Condensated water test cabinet - Cab series

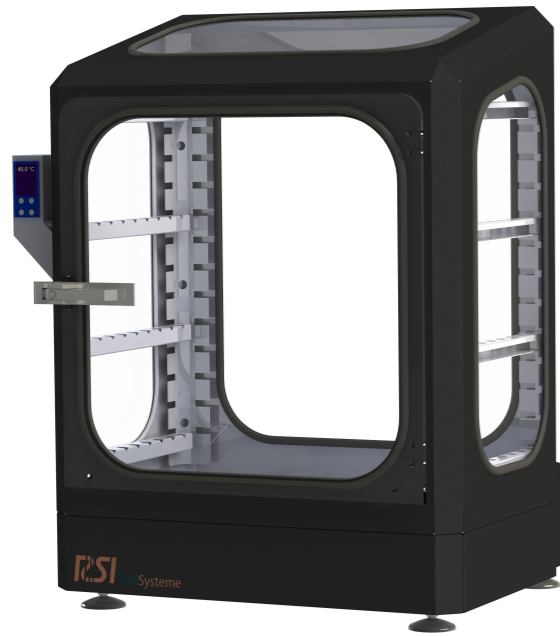

Suitable for many national and international test standards

ISO 6270-2 CH.AT.AHT
ISO 6988 / DIN 50018

with additional options
fully automatic tests with and without corrosive gas

Condensated water test cabinet - Cab series

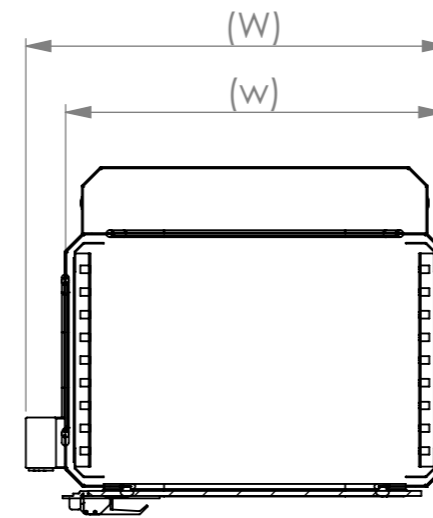
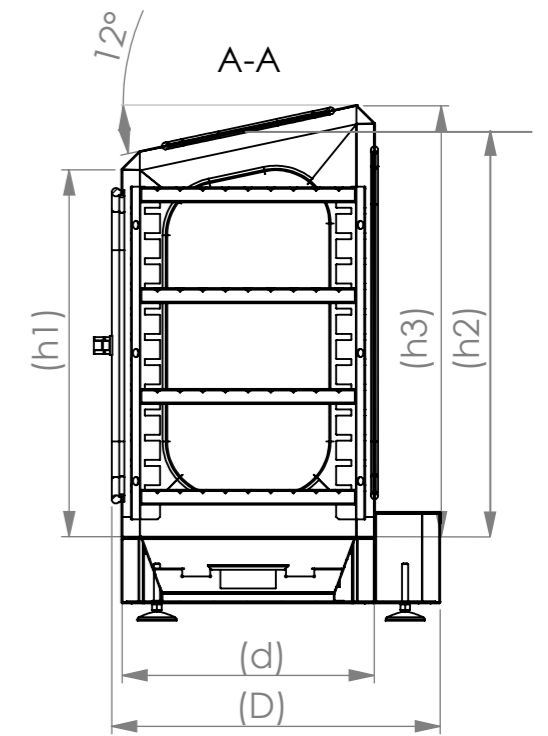
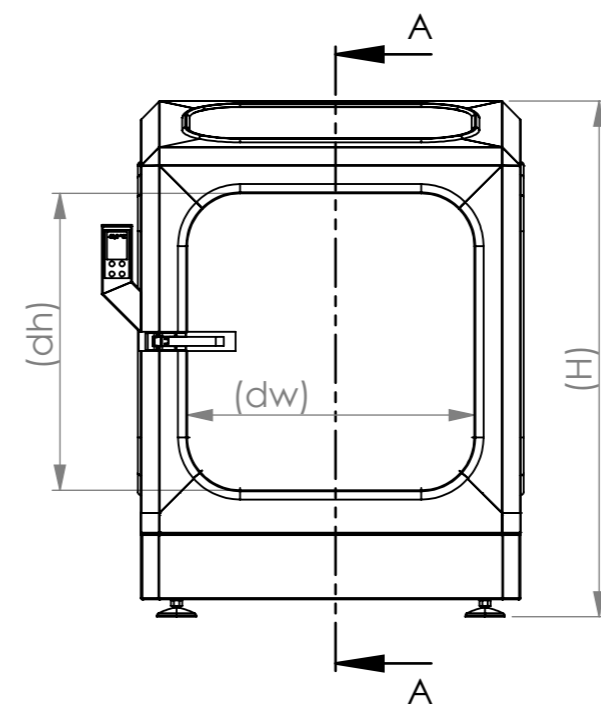

Cab		300	415	850
chamber width [mm]	(w)	750	850	1000
chamber depth [mm]	(d)	500	600	850
chamber height [mm] (upto begin roof pitch)	(h1)	760	760	882
chamber height [mm] (upto roof top)	(h2)	810	820	1000
chamber height [mm] (upto middle of the roof)	(h3)	860	880	1082
door dimensions [mm] (width x height)	(dw x dh)	580x600	680x600	880x880
outer depth [mm]	(D)	640	740	940
outer width [mm]	(W)	830	930	1080
outer height [mm]	(H)	1000	1020	1240
power		1100 Watt	1100 Watt	2100 Watt
chamber material		stainless steel		
chamber heating		heating via test chamber bottom		
chamber temperature (max)		60°C (opt. 70°C)		
bottom water outlet		yes	yes	yes
weight		65 kg	75 kg	130 kg

02/2020

